

Email Server Communication Errors

Finding Communication Errors

It is possible, that if some of the system settings and classic system settings are not setup correctly to use a **From** address, that you will receive a communication error as a response. One example would be when trying to submit the **Forgot Password** form found on the user side login page. An error message of this nature would look something like this:

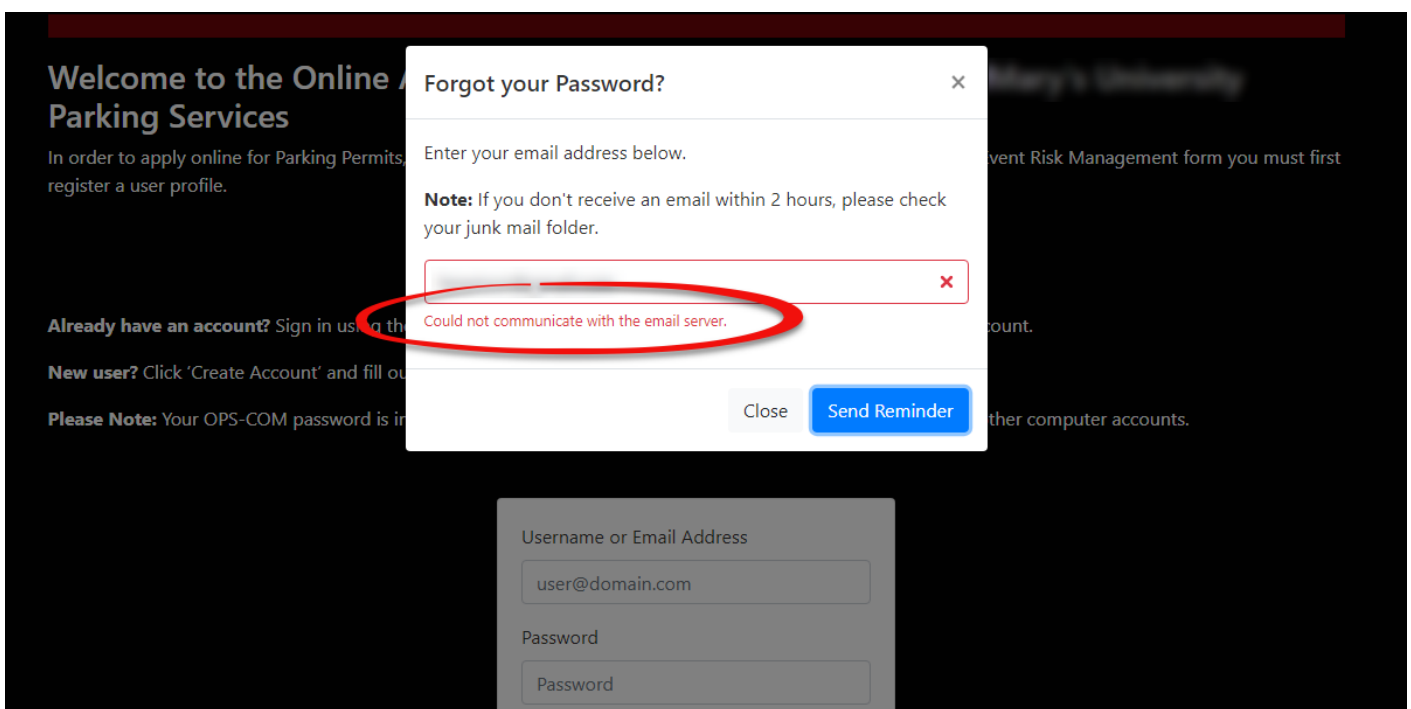

As mentioned, this is because there is no **From** address setup in the system.

Fixing Communication Errors

To fix this issue you would just need to update the **Reply-to Admin Email Address** found under **Classic System Settings**.

Edit System Config

System Name	Parking Services	
System Description	Parking Services	
Reply-to Admin Email Address		
Reply-to Security Email Address		
Mailing Address		

Once you have updated the email address this issue should be resolved. If the issue is still not resolved after completing these fields, please contact support for further assistance.