

Setting Device to Auto-Update

1. Open **Google Play Store**.

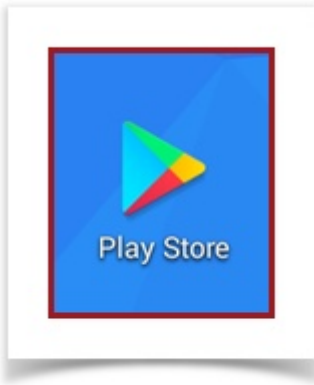

2. Tap the **hamburger icon** (three horizontal lines) on the **top-left**.

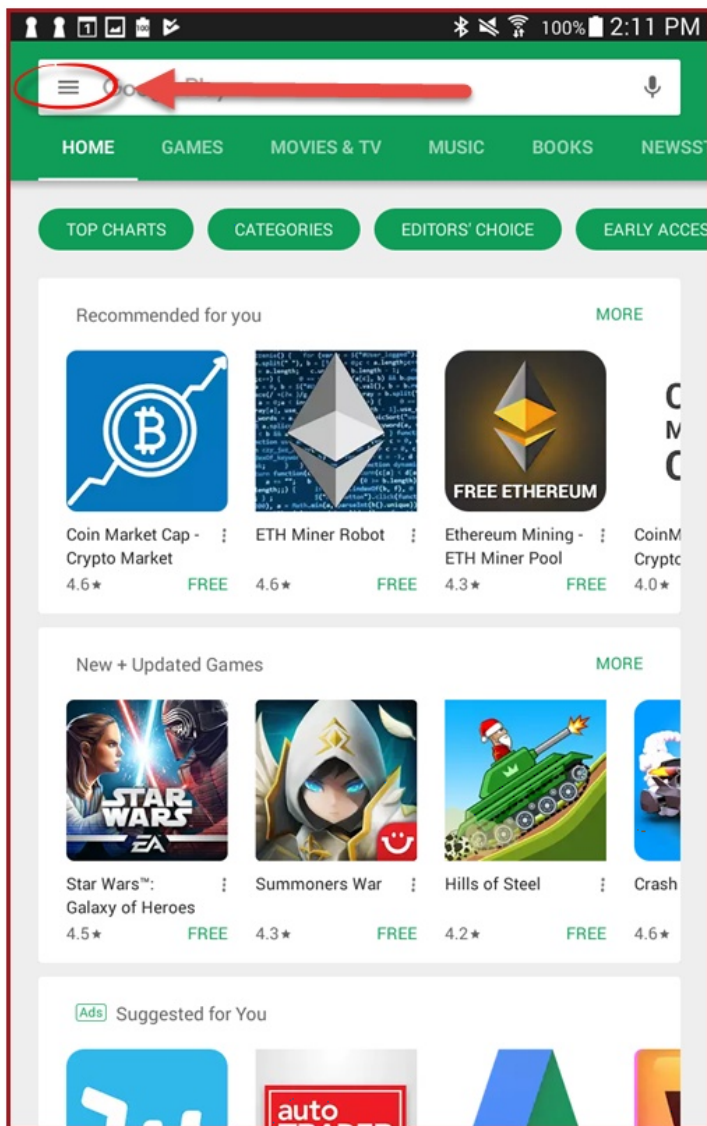

3. Tap **Settings**.

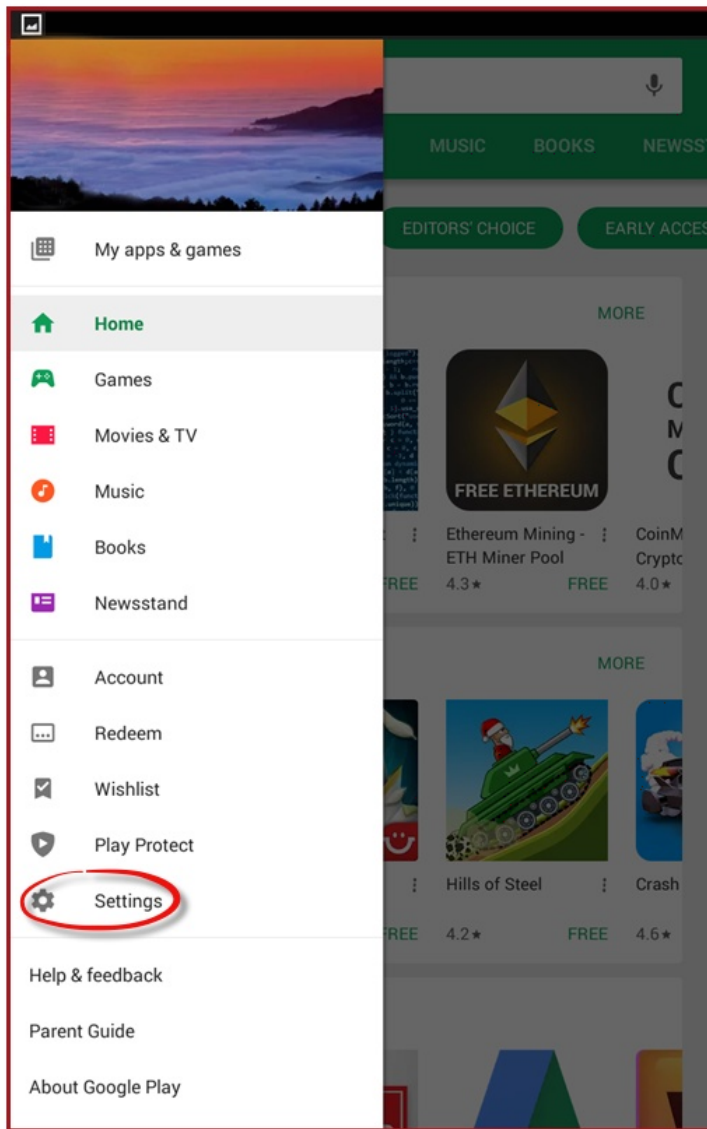

4. Tap **Auto-update apps**.

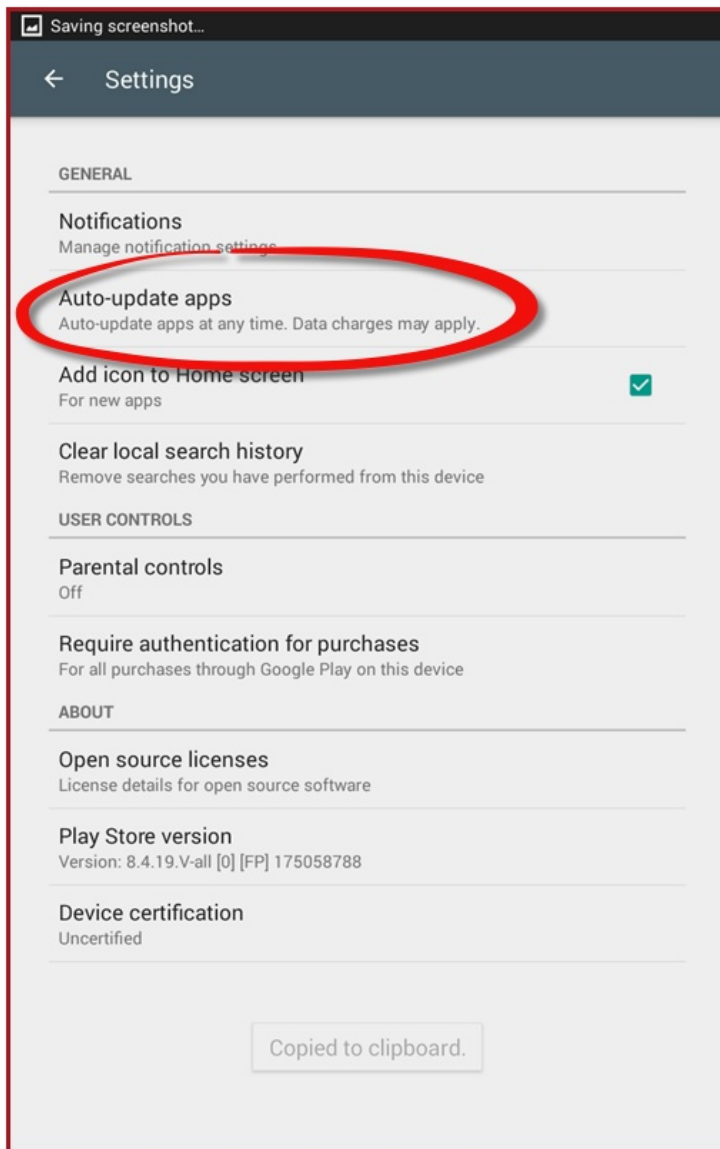

5. To **enable** automatic app updates, select **Auto-update apps at any time. Data charges may apply.**

To **disable** automatic app updates, select **Do not auto-update apps.**

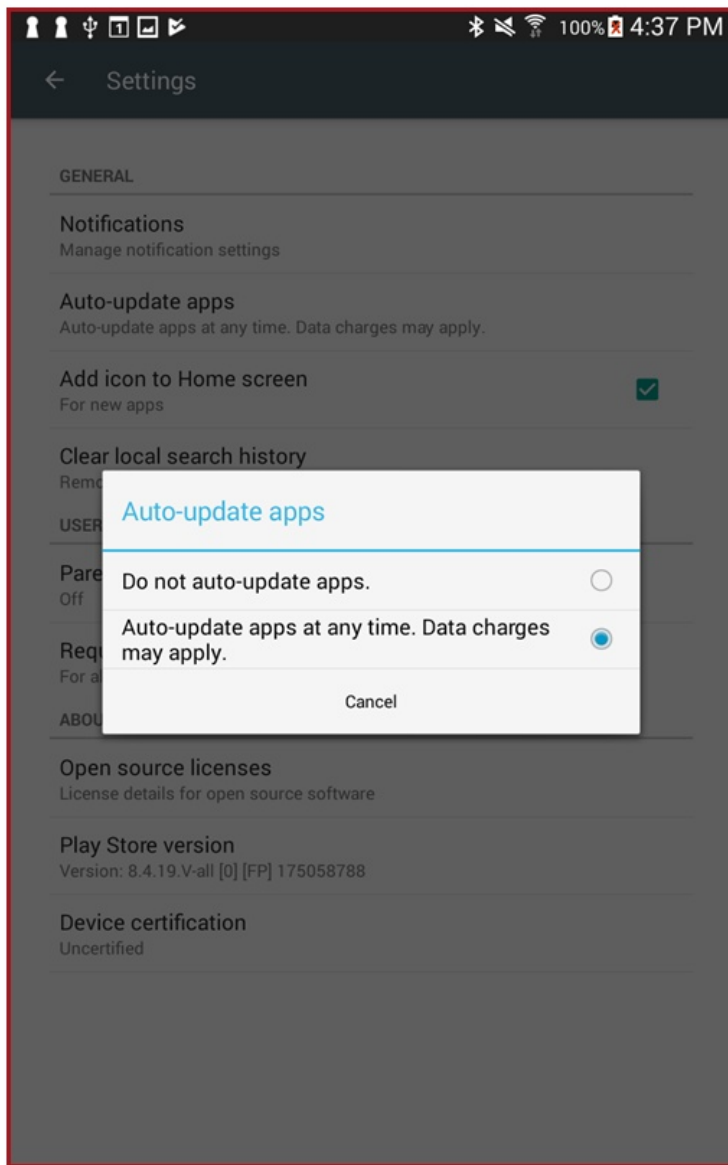

Revision #2

Created 29 April 2024 11:47:06

Updated 11 September 2024 13:40:49