

# Locate Application Version

“ If in doubt you can search for the OPS-COM application in the Google Play Store and when viewing the details of the application you will see the button that is typically labeled "Install" will instead show "Update". This indicates that the handheld is running an older version of the application which can be updated.

## Locate the Version Details

### Login Screen

Under the login box the version details and handheld identifier are clearly listed.

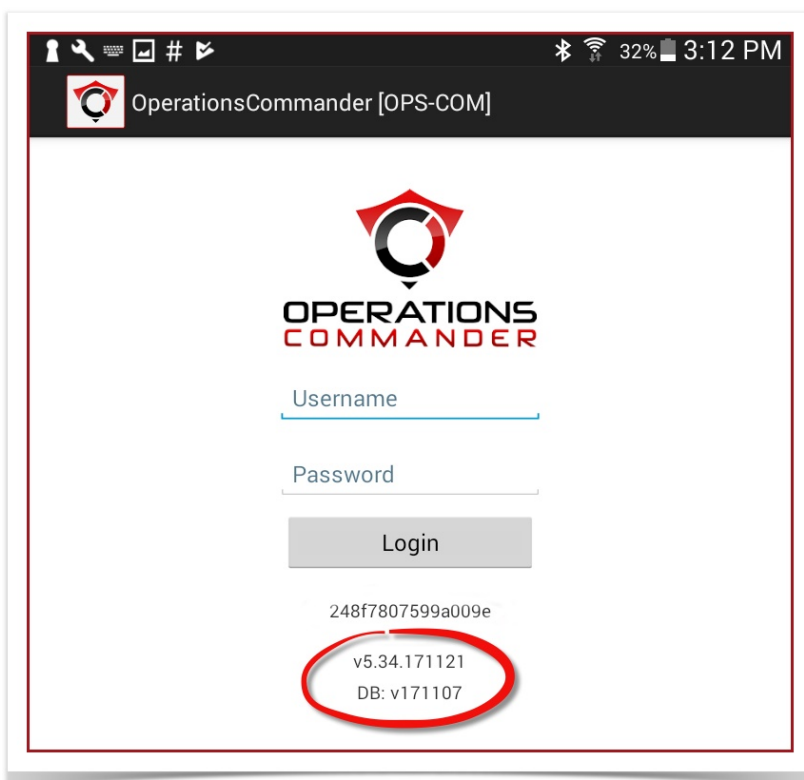

### About Screen

Select the About menu option.

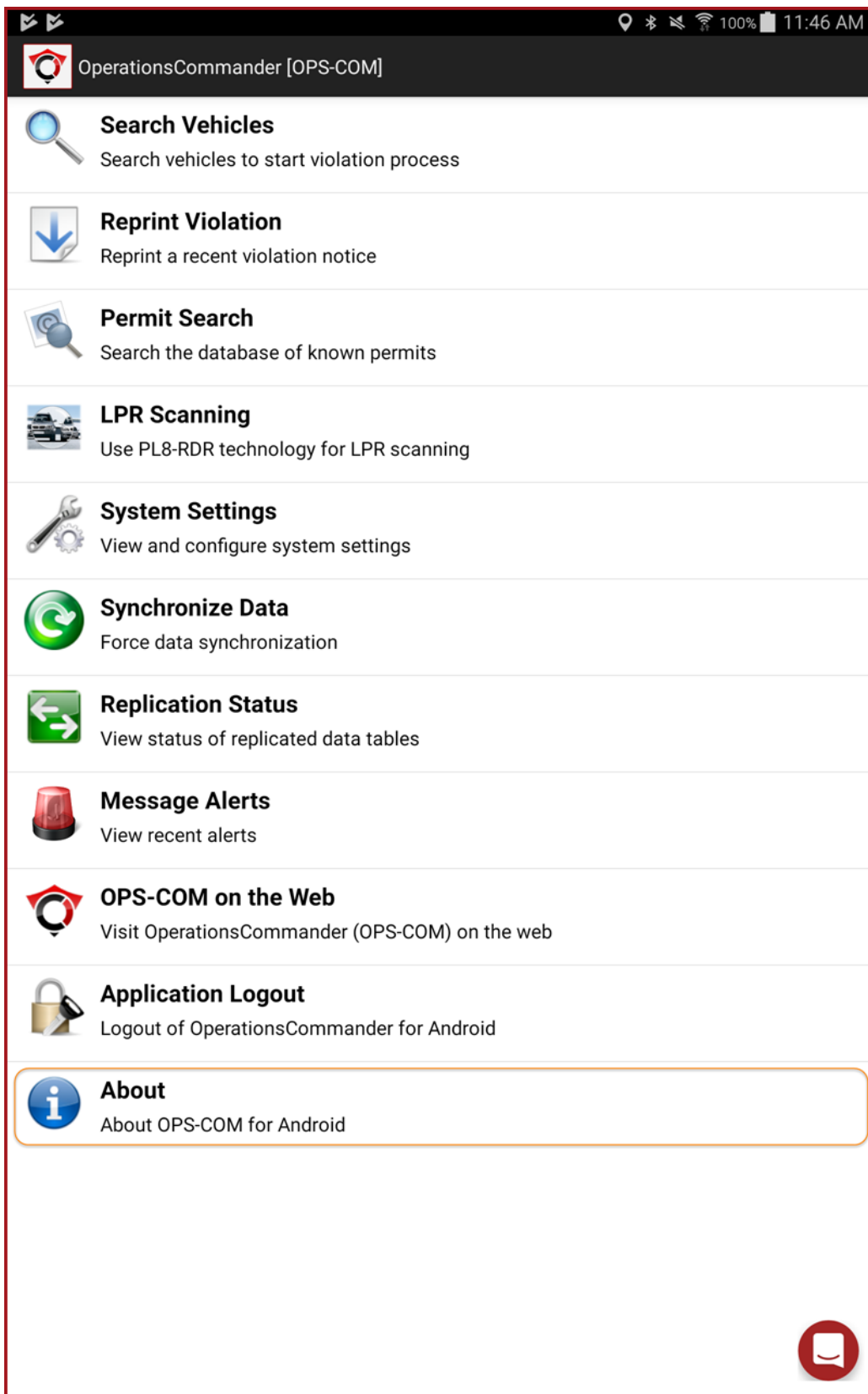

A pop-up message will display a brief description of OPS-COM application including the version number.

Tap OK to go back to the main menu.

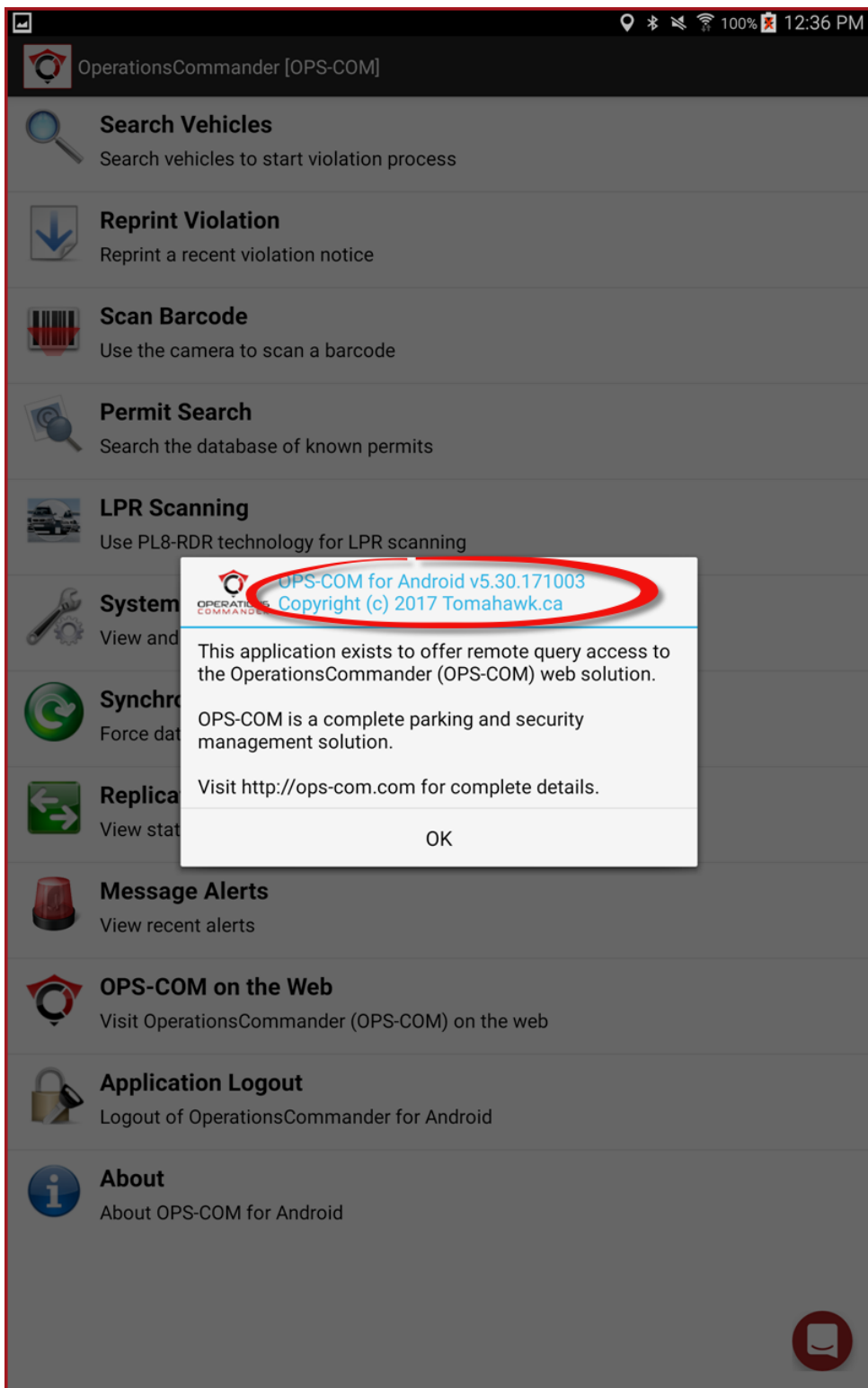

1. Alternately you can find the version number on the login screen.

Revision #2

Created 2 February 2024 13:37:45 by Robin

Updated 29 May 2024 07:17:17